

# 22m Multicat

## MC22

24m multi-purpose workboat.

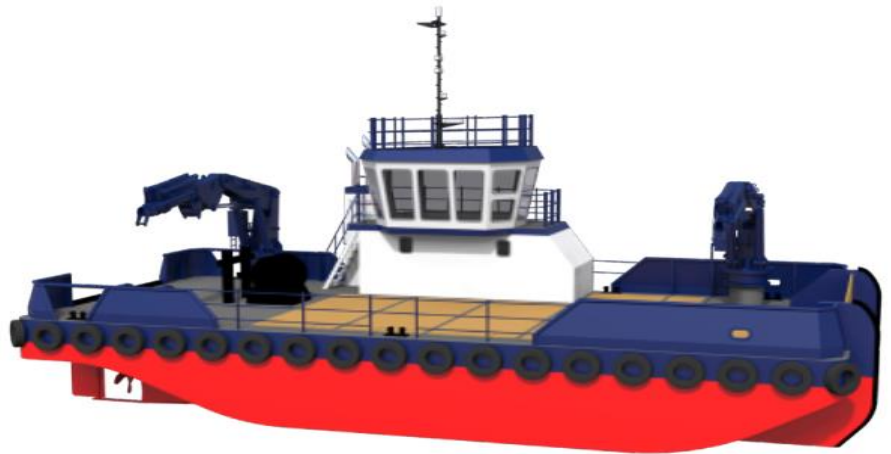

## 20m – 24m Steel Multi Role Workboat

Harbour Maintenance – Dive Support – Aquaculture - Support



PDL Marine are proud to present the 22m Multicat. Also available in 20 and 24m.

An exceptional vessel that bats way above its size, suitable for a multitude of tasks such a buoy maintenance, harbour works maintenance and support, survey work and dive support as well as the aquaculture industry.

The vessel can also be fitted with seating for up to 12 personnel for transfers within the superstructure if required.

A huge deck cargo capacity of over 120 tonnes, really does make this a formidable workboat.

Fitted with twin Doosan V158TIH or V222TIH engines helping to push the vessel along and provides bollard pull up to 15 tonnes and more if required., other engines are available.

The vessel is built to MCA category 2 standards and can be built to class.

Other equipment includes but not limited to:

Deck winches, Capstans

10T Hydraulic A Frame

Accommodation and Galley available.

# 22m Multicat

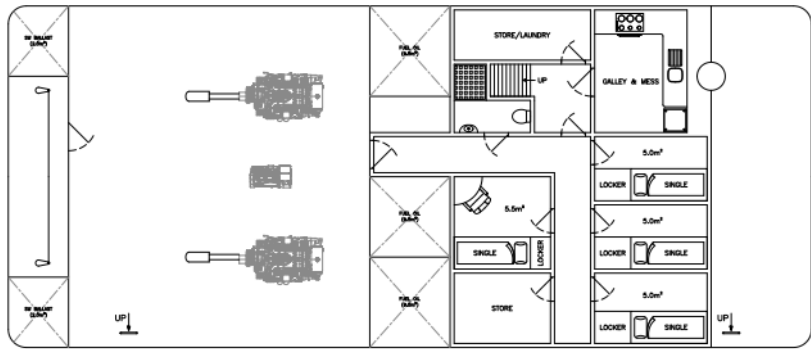
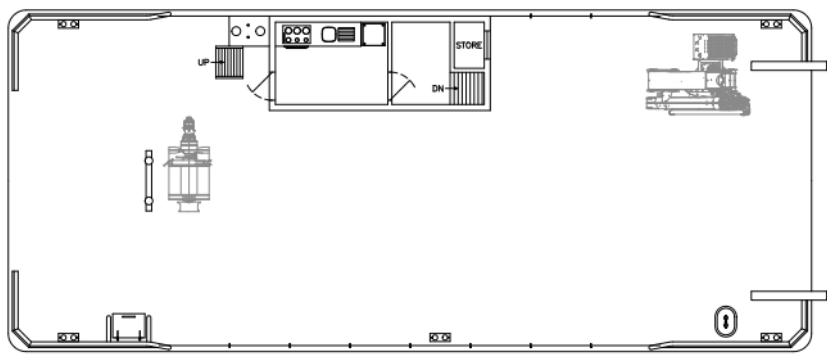
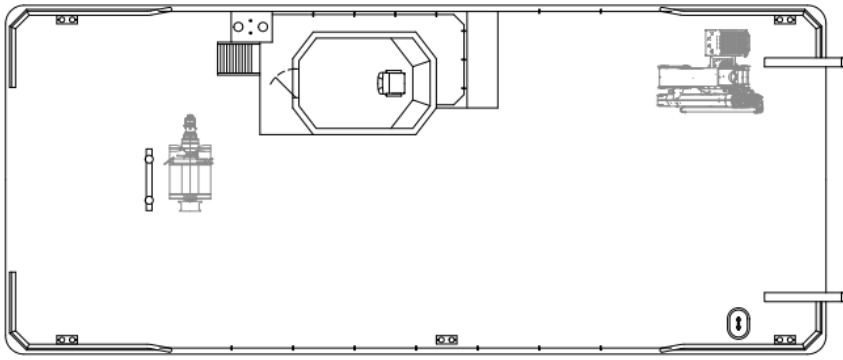
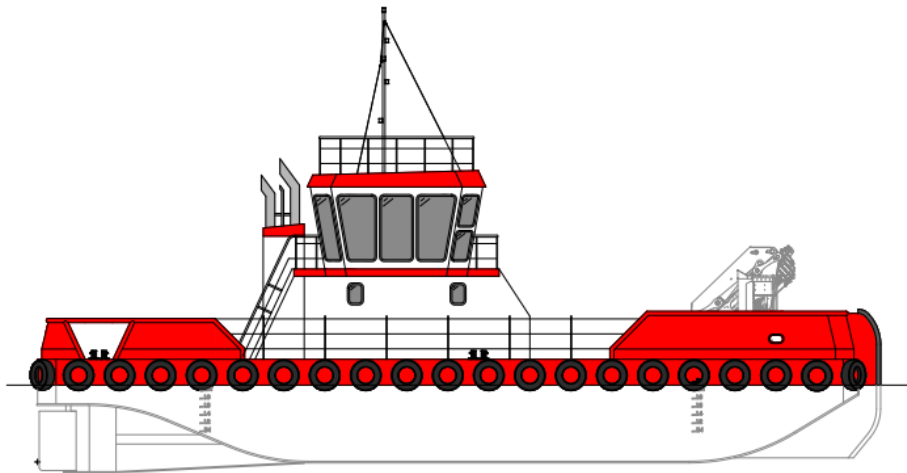

Length Hull	22.55 m
Length Waterline	21.80 m
Length Overall	22.55 m
Beam Hull	8.50 m
Draft	2.14 m
Power	Twin Doosan L158TIH or V222TIH
Service Speed	8.5 Knots
Maximum Speed	9.5 Knots
Additional power available.	
Fuel Oil	28,500 Litres
Fresh Water	1,000 Litres
Black Water	1000 Litres
Deck Cargo	120 Tonnes
Crew	3
Passengers	12 (this variant)
Deck Crane	Hydraulic Knuckle-Boom
A Frame	10 Ton hydraulic
Capstans	
Tugger winches	
Accommodation, Galley,	
Can be built to class standards	